

Welcome to Tiger Winches

Our Tiger range of winches are all of the planetary design and are rugged in construction and very well engineered. These winches are light weight, though very strong. They are built with a precision two stage planetary gear box and use quality roller ball bearings throughout.

The Tiger winch is supplied with a high starting torque motor which has been specifically designed and manufactured for hoisting applications. For your safety and piece of mind, they also include a fail-safe electro magnetic disc brake which provides safe, easy control of your loads.

FO5 - 20



TIGER WINCHES

Small Light Weight Boats

Lifting Capacity - 200 KG

Quick Guide To Tiger Winches		
Slope	Gradient	Weight
*eg. (1 : 12)	5°	2200 kg
(1 : 4.5)	12.5° *	900 kg
(1 : 3.75)	15°	750 kg
(1 : 2)	27°	400 kg

*Standard boat ramp angle.

* eg. Slope = (1m fall : 12m in length)

Note: Based on rolling load over good quality surface.

STANDARD FEATURE

- 30m of wire rope with safety hook
- Average line speed 10m per minute
- Weight approx. 35kg
- Forward and reverse pendant control, 3m lead with 3 pin plug
- **Optional radio remote control**
- **Optional 24 volt hand control**
- **240 Volt (Standard Model)**



Easily mounted

APPLICATIONS

- Boat ramps
- Small workshops
- Crane and lifting
- Home handyman
- Positioning caravans or large trailers in confined areas
- Lifting sillage pumps
- Ideal for building sites
- Industrial bin retrieval
- Agricultural environments, water pump installation and removal



High torque torque motor



Electronic fail-safe brake



Proudly distributed by **McDowall Engineering**
 Ph: +61 7 3881 3562 Fax: +61 7 3881 3567
 Email: enquiries@mcdowallengineering.com.au

TIGER WINCHES

Technical information

Capacity Guide

Part Number	Hoisting Capacity (kg)	W / Rope Capacity (mm x m)	Motor Data (kw / v)	Line Speed (mpm)	Net Weight (kg)
F05-20	200	6 x 30	.55 / 240	10-15	29
F05-25	250	6 x 30	.75 / 240	10-15	32
F06-30	300	8 x 30	1.1 / 240	12-18	40

Mounting Guide

		F05-20	F05-25	F06-30
Hole	A	10mm	10mm	14mm
Bolt Size	A	8mm x 4	8mm x 4	12mm x 4
Dim.	B	142mm	142mm	186mm
	C	142mm	142mm	160mm
Winch	D	485mm	540mm	557mm
Dim.	E	190mm	190mm	250mm
	F	261mm	261mm	280mm

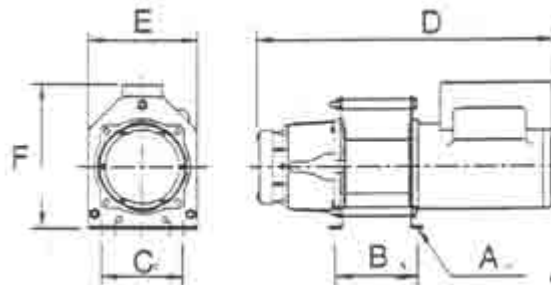

Proudly distributed by **McDowall Engineering**
 Ph: +61 7 3881 3562 Fax: +61 7 3881 3567
 Email: enquiries@mcdowallengineering.com.au